



Cornhill Lane

Boston, PE21 6EZ

£106,000

TOWN CENTRE house with PAVING SPACE and enclosed rear GARDEN; living room and dining room plus TWO BEDROOMS; kitchen and bathroom and gas CENTRAL HEATING. The property is currently LET on a fixed term AST of £595pcm. A current gas safety certificate is held and a valid EICR to August 2025.



Cornhill Lane, Boston, Lincolnshire, PE21

Accommodation

Living Room 13'3" x 14'6" (4.04 x 4.42)

With laminate flooring and central heating radiator, t.v and telephone points, window to the front and twin doors to the rear courtyard and stairs to the first floor.

Dining Room 11'5" x 8'3" (3.48 x 2.54)

With laminate flooring, central heating radiator and window.

Kitchen 12'11" x 7'8" (3.96 x 2.34)

Fitted with a quality range of matching wall and base units, return work surfaces with inset sink and splash tiling, cooker recess, wall mounted gas central heating boiler, space and plumbing for washing machine, window and door to the rear courtyard

First floor Landing

Bedroom One 14'2" x 9'10" (4.34 x 3)

With window and central heating radiator.

Bedroom Two 12'9" x 7'10" (3.91 x 2.39)

With window and central heating radiator.

Bathroom 9'6" x 8'2" (2.92 x 2.49)

Comprising: freestanding roll top bath and separate shower cubicle, w.c and wash hand basin, window and heated towel rail.

Outside

The property has an enclosed patio courtyard with gated access to the rear. There is also an allocated parking space.

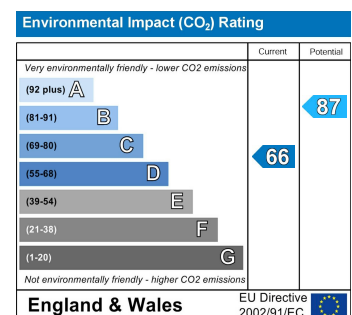
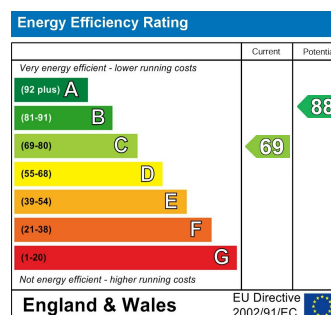
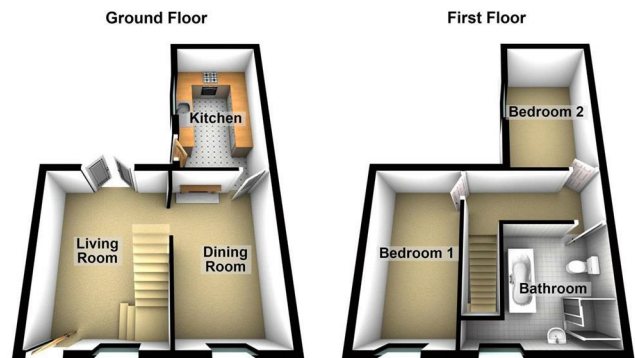

Cornhill Lane, Boston, Lincolnshire, PE21



Zoopla.co.uk

PrimeLocation.com

rightmove.co.uk
The UK's number one property website

OnTheMarket.com
coming January 2015

The Property Ombudsman
APPROVED CODE
The National Association of Estate Agents

f

t

NAEA
National Association of Estate Agents

Printed by Ravensworth 01670 713330

"Once you find the property you want to buy, you will need to carry out more investigations into the property than it is practical or reasonable for an estate agent to do when preparing sales particulars. For example, we have not carried out any kind of survey of the property to look for structural defects and would advise any homebuyer to obtain a surveyor's report before exchanging contracts. If you do not have your own surveyor, we would be pleased to recommend one. We have not checked whether any equipment in the property (such as central heating) is in working order and would advise homebuyers to check this. You should also instruct a solicitor to investigate all legal matters relating to the property (e.g. title, planning permission etc) as these are specialist matters in which estate agents are not qualified. Your solicitor will also agree with the seller what items (e.g. carpets, curtains etc) will be included in the sale".